

Brenda Wheaton



Membership Co-Chair



Don Allison-Smith



Membership Co-Chair

2009 Membership Drive

Dear Members,

The Parrsboro Culture and Wellness Centre will be a place where our culture will flourish and grow. As a member of the Parrsboro Band Association and its mission to "Save The Hall", we hope that you will be pleased with your association's progress this year. A small team of volunteers has carried the dream forward and now it is time to replenish the coffers and regenerate commitment. All of you, our 600 members, can help by simply renewing your membership. You can help even more by occasionally contributing time.

This year we ask a little more of you: not only an increase in the membership fee, from 5 to 10 dollars, but also a request that, should you be able, you increase your involvement by offering volunteer services and by encouraging others to become members. In order to attract government funds and corporate donors we need proof of a strong and dedicated community. Remember, we are a registered charity offering tax receipts for donations. Please be as generous as possible as we move into the next phase of our development. This year we have added a list of volunteer activities. The size and scope of this project is enormous. Opportunities to fulfill the vision abound. Simply put: the more volunteers, the easier the job. Please 'check' your area of interest and reap the reward of knowing that you did your part to help turn a worthy vision into a vivid reality.

We've made it easier to renew or to become a member.

You can either fill out the flip side of this membership form and mail it in to

The Parrsboro Band Association

PO Box 712

Parrsboro, NS B0M 1S0

or

Go to our website at www.thehall.ca and simply fill out the membership form and through PayPal pay your membership and/or donation.

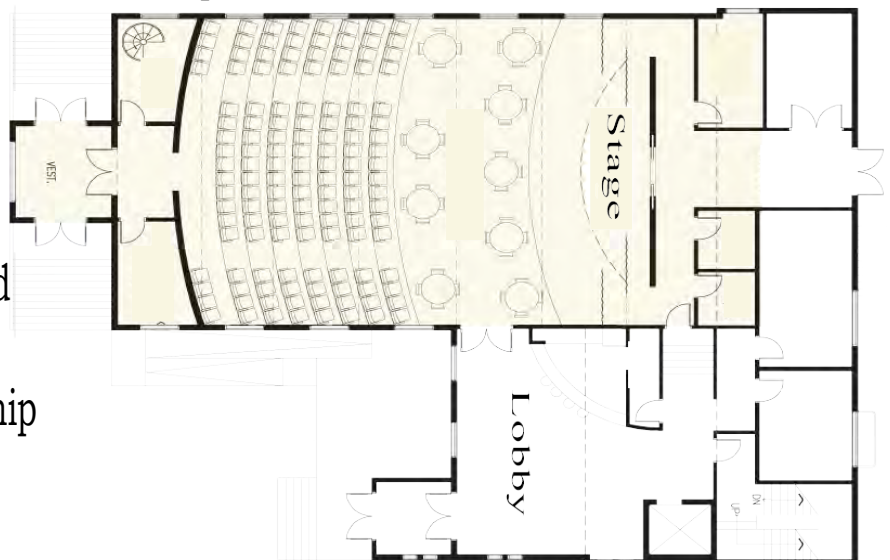

Membership Renewal

Name _____

Address _____

City _____ Postal Code _____ Country _____

Telephone Number _____

e-mail address _____

Membership \$10 _____ \$ _____

Additional Family Members \$10 _____ \$ _____

Additional Family Names (please print) _____

Gift or Donation _____ \$ _____

capital operations either

total contribution \$ _____

You can be confident that your private information will not be shared.

How You Can Help as a Volunteer

We could use your help if you have some spare time. Just check off the areas that interest you.

Would you like to work with one of the committees or maybe now and again for special needs?

Committees:

- Band*
- Capital Development*
- Communications*
- Concert Series Committee*
- Events - (fundraising)*
- Facility*
- Film*
- Finance*
- Fund raising - Capital*
- Fund Raising - Operations*
- Membership & Volunteer*

Specific Tasks:

- Baking*
- Billet (provide accommodation for visiting performers)*
- Carpenters, etc. for specific projects*
- Computer work -- Database entry - web site*
- Decorating & set-up for events*
- Facility maintenance*
- Graphic design (producing posters, tickets, etc.)*
- Grant writing*
- Painting*
- Poster distribution*
- Providing contacts for fund-raising*
- Telephone calling*
- Ticket sellers (for events, raffles, etc.)*
- Other- please specify*

Building a better future for the people of Cumberland and Colchester